

Invisible Edge EDGE



INSTALLATION INSTRUCTIONS

We recommend Invisible Edge system be installed by a professional tradesperson. Consult a landscape, tiling or plumbing professional about your installation requirements. Tiles must be installed to support waterflow into the drainage system.



RECYCLED PLASTIC · RUST FREE

THE SYSTEM.

Connects to all EasyDRAIN™ Standard components

Invisible Edge
Channel & Grate
SKU code: 83306

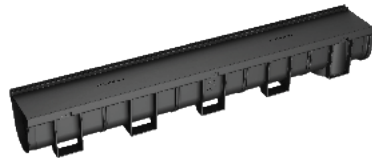

100mm profile makes for easy installation and is suitable for areas with low rainfall and waterflow

Invisible Edge
Access Pit & Grate
SKU code: 83806



The Access Pit is where debris will collect. This is your access point to clean the drainage
* see installation video for demonstration

Invisible Edge
Internal Corner & Grate
SKU code: 83336I



Allows for an easy change of direction. Layout drainage to identify the suitable corner for installation
* see installation video for demonstration

Invisible Edge
External Corner & Grate
SKU code: 83336O



Allows for an easy change of direction. Layout drainage to identify the suitable corner for installation
* see installation video for demonstration

Invisible Edge
Heel Friendly Insert
SKU code: 83230



Converts system to heel friendly option for pedestrian activity
* see installation video for demonstration

Invisible Edge
End Cap
SKU code: 83360



Provides a finishing point to the channel & grate. Acts as a connector to 90mm PVC stormwater pipe (using the cut out feature)

Invisible Edge
Converter
SKU code: 83370



Acts as a joiner between cut end of EasyDRAIN™ Edge Channel. Connects together male ends of channel to corners or end cap

INSTALLED SYSTEM.

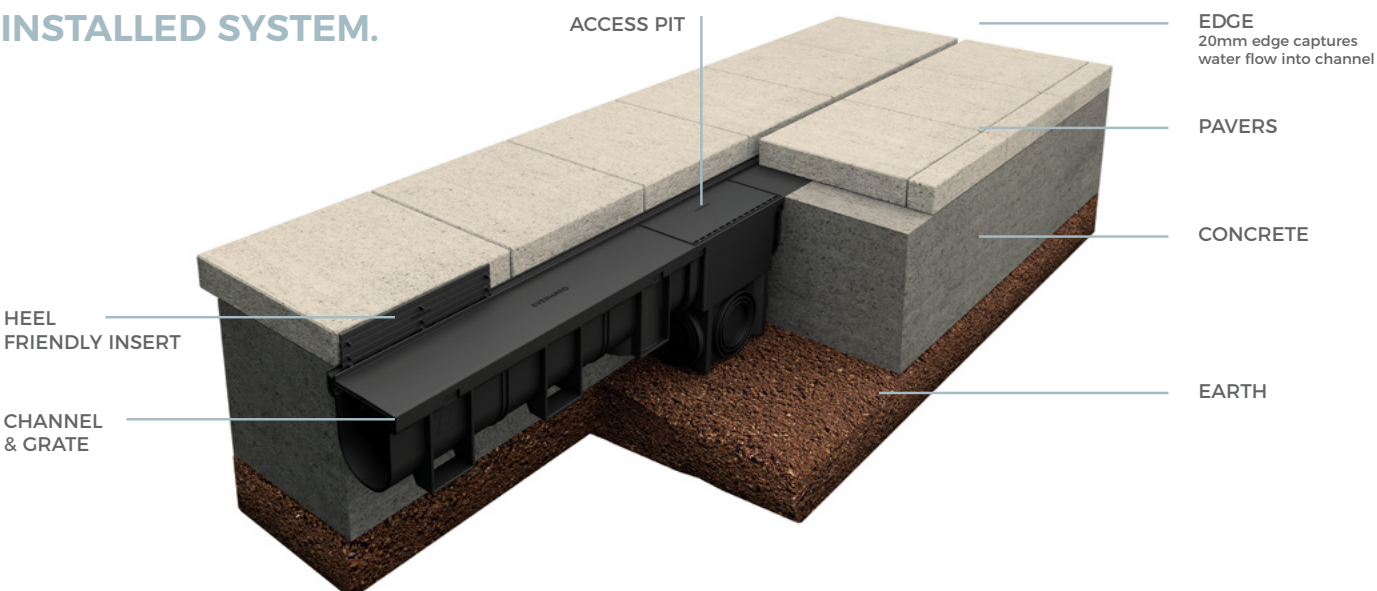

PREPARE

- / Confirm which components of the system you'll need for the area and lay them out in order as you would install them
- / If required cut the channel to fit your area (refer to the CONNECTION INSTRUCTIONS)
- / Dig your trench 2 inches deeper and 2 inches wider than the channel being installed and no less than 3 inches wider than the width of the channel at its lip
- / Slope the trench at a ratio of 1% for every length of channel minimum
- / Position the Invisible Edge Access Pit at the lowest point of your slope for cleaning purposes
- / If you are using PVC pipes, ensure your trench size suits this
- / Use a string line to ensure straightness and the correct finish height
- / Fit grates into the channel prior to installation
- / Connect your Invisible Edge Channel & Grate with other components to complete your drainage system
- / Connect the end cap to the highest point of your channel
- / To connect channel to a PVC pipe, cut a hole in the base of the channel, access pit or end cap as required, guided by the outlet collar, and seal with silicone

INSTALL

- / Pour concrete slurry in the base of the trench
- / Place the channel and grate into the trench and push the channel into the concrete slurry so the feet of the channel are completely immersed
- / Pour concrete down each side of the channel, ensuring base is completely immersed

FINISH

- / Lightly compact and finish the concrete level with the lower edge side of the grate
- / Your tiles are ready for installation.
- / Make sure the tile over the access pit is removable for cleaning purposes
- / Insert the heel friendly gap once your tiles have been installed - no sealing necessary

AFTER INSTALLATION

Clean your drainage system at the access pit where debris will collect. To clean, lift the tile/paver and the access pit grate and remove the debris from the pit
The Invisible Edge Edge Grate is not locked into the channel, if you need to have access to the channel in the future, ensure tiles are installed to be removable.

HEEL FRIENDLY INSERT

The insert is made to 2 inches height tiles/pavers, using a utility knife you can cut the Insert to fit to the height of the tile/paver. The insert is 10 inches wide, using a utility knife you can also cut this down to suit the channel length

CONNECTION INSTRUCTIONS

You only need to refer to the **connection instructions** if you have cut the channel to suit your desired length.

The Invisible Edge Channel is manufactured with female and male ends so they can be joined by clicking together. When cutting the channel to suit your desired length, you will need an Invisible Edge Converter for the cut piece. This will then click to another piece of channel or the Invisible Edge End Cap.

1.

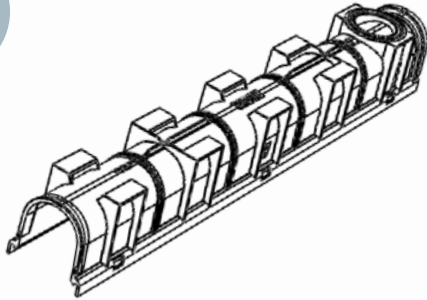

Remove the grate from the channel. Flip the channel upside down and use a saw to cut between the ribs that are 8 inches from the female end.

Trim the ends with a utility knife to remove excess plastic. Now you will have a channel with a male end. To cut the grate, place back into cut channel and mark the cut area. Remove grate and cut using a cutting disk to create a neat edge.

2.

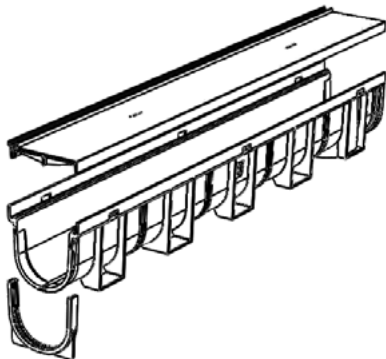

Put your grate back into position. Use your Invisible Edge converter to convert the male end back into a female end.

3.

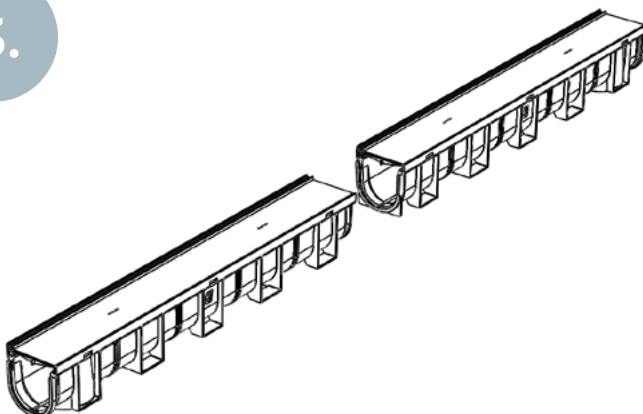

Now the cut channel and grate can be connected to another channel length or Invisible Edge End Cap